

CLAPHAM & DISTRICT NEWSLETTER

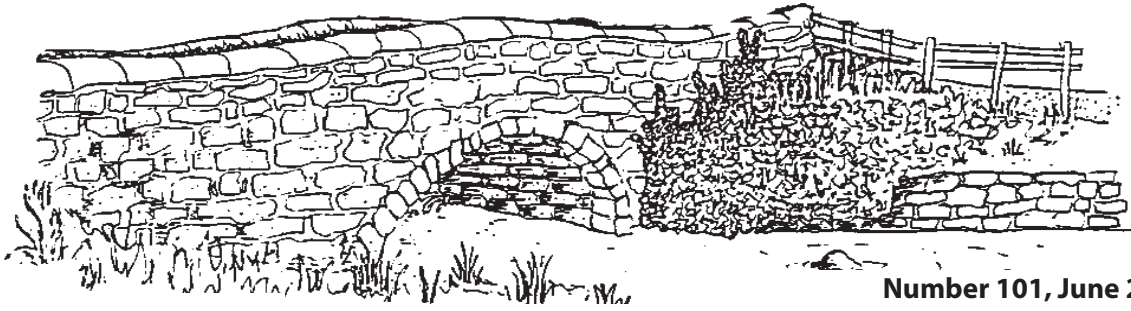

Number 101, June 2016

Honouring our Queen's 90th



The Parish Choir in the beautiful setting of Hall Garth's front lawn entertaining the visitors

The scene at Hall Garth on Sunday, June 5th truly was set in an idyllic English country garden. Jane and John and the Ingleborough Estate generously offered to open the gardens for the afternoon and they provided the perfect setting for a celebration of the Queen's 90th birthday.

The garden looked beautiful and the fundraising stalls set the scene off well with their green and white awnings. There were cakes by the mile (and, of course, tea), the occasional crown was spotted and, what's more, the sun just shone and shone.

The Parish Choir came along to entertain and there were healthy renditions of the National Anthem and Happy Birthday to You, with greetings to a couple of 'commoners' added to the list for good measure.

Both villagers and visitors came along and enjoyed the occasion which was a true community event. We would all like to think that Joan and John would be delighted to see their beautiful garden being enjoyed by so many and truly at the heart of the village. *Sue Mann*

See page 13 for more photos and page 10 for the birthday beacon

Clapham Village Hall

A cleaner is required for the Village Hall. The work involves just two hours per week in the cleaner's own choice of time.

We are also looking for anyone wishing to join the committee. We meet three times a year – the next meeting is on Wednesday, October 19th at 7 pm.

There will be a Quiz Night on Friday 7th October.

BUS SERVICES (581)

Clapham to Settle (weekdays):

0734 0909 1109 1309 1509 1719

Saturdays:

0734 0909 1109 1309 1509 1719

Settle to Clapham (weekdays):

0930 1130 1330 1530 1740 1830

Saturdays:

0930 1130 1330 1530 1740 1910

Newby B4RN Broadband

We have begun the work that will bring B4RN (Broadband for the Rural North) fibre broadband to Newby and the houses on the west side of Cross Haw Lane, Clapham.

The route is coming up the back of those houses in Cross Haw Lane, along the south side of Laithbutts Lane footpath to the rough triangle at Tenter Hill, at the top of the village. There it will split – part running to the north and west, the other east and south, round to the former 'Little Chef'. There will be 'gaps' in the work as we wait for fields to be cut for grass.

Several people have already contacted me, or the Clapham B4RN project team, to express interest. If anyone would like information, or who wants connection, please contact info@claphamhyperfast.net or me, John Elphinstone, at dianeelphinstone@gmail.com or telephone 51318.

There are some houses that we cannot reach directly from the edges of the village, and we would ask that, even if you do not want connection yourselves, you will allow us to come across the ends or edges of gardens to reach those in the middle.

John Elphinstone

Village Hall Notice Board

Clapham Parish Council

4th Tuesday Evening of the month at
7.30 pm



Gillian Muir 51775

Clapham Art Group



Tuesday Evening
Linda Clemence
01729 823767



Tiny Tots

Tuesday Mornings
9.30 am to 11 am

Tracey Bilton
51857



Bowls

Monday
Afternoons
1.30 am to 4 pm
Mrs. Denne 51617

Whist
Friday Evenings
7.30 pm



Elsie Morphet
07951 295995

Clapham W.I.



2nd Wednesday
Evening
of the month
7.00 pm

Jill Walker 01729 825358

Tai Chi

Thursdays
9 am to 10.30 am



Tony Bennett
c/o 51240



1st Wednesday
Morning
of the month
11 am
Brenda Pearce
51816

CHURCH NEWS

The Vicar's thoughts . . .

Sea Sunday – July 10th, 2016 **The legacy of the Revd John Ashley**

In 1856 the world looked very different from today, but it was in that year that founder, the Revd John Ashley, changed the course of history. Standing on the coast, looking out over the Bristol Channel, he saw hundreds of sailing ships at anchor far from shore and he devoted the rest of his his life to preaching the Good News of Jesus to those at sea.

Today the legacy of Ashley's visionary work with seafarers continues with vigour, dedication and energy. More than 100 ordained and lay chaplains are funded by the Mission, and work alongside thousands of dedicated ship-visiting and Flying Angel Centre volunteers, bringing working crews support, friendship and love. This work is mostly unsung and unseen, yet it still flourishes across the worldwide Anglican Communion in 200 ports in more than 50 countries.

2016 is the 160th anniversary of the Mission to Seafarers, and throughout those 160 years they've been in integral partnership with, firstly, the Church of England and, later, as the work developed, with the wider Anglican Communion. It is a relationship that remains at the heart of all that they do. '160 year' is the theme of this year's Sea Sunday celebration. To reflect on the past, and to give thanks for what has been a great mission story, is important. However, the primary focus of Sea Sunday is to celebrate the life and work of today's seafarers, the 1.5 million on whom we are all so dependent and yet who are so often forgotten. They and their families face many challenges and the Mission's work with them in more than 200 ports around the world remains absolutely vital. It is work that could not continue without your prayers, your friendship and your practical generosity.

The Mission to Seafarers has gone through a number of changes recently and there have been a range of exciting new developments, including ground-breaking family projects.

We are all acutely aware of the current fragilities and uncertainties of the world in which we live. That sense of growing insecurity is one of many things that can impact negatively on the lives of seafarers. It also affects a number of chaplaincy teams around the world. In such a context, it can often be hard to raise the profile of seafarers, and church communities face so many demands on their time and resources.

We will remember the Mission for Seafarers at our Services on Sea Sunday, July 10th.

Blessings as ever, Ian

CHURCH SERVICES IN JULY

Sunday, 3rd – 11.00am Holy Communion at Clapham and Keasden.

Sunday, 10th – 11.00am Holy Communion at Clapham. 11.00 am Family Baptism at Eldroth.

Sunday, 17th – 11.00am Holy Communion at Clapham. 6.45pm Evensong at Keasden.
7.00 pm Evensong at Eldroth.

Sunday, 24th – 11.00am Holy Communion at Clapham. 2.00 pm Evensong at Keasden.

Sunday, 31st – 10.30am United Service at Keasden.
7.00pm Church in the Pub at The New Inn, Clapham.

DIARY DATES FOR JULY

Saturday, 2nd – Annual Cream Teas at Eldroth Church from 2.00 – 4.00pm £2.50. More information from 015242 51446.

Saturday, 9th – Parish Walk, please meet at Austwick Church at 9.30am.

Sunday, 10th – The Mission to Seafarers' Sea Sunday. Celebrating 160 years of caring for seafarers and their families around the world.

Donations for this valuable work can be sent to Freepost, The Mission to Seafarers, London EC4B 4EP or visit www.missiontoseafarers.org

Thursday, 21st – School Leaver's Service in Clapham at 2.00 pm.

Saturday, 23rd – Clapham Street Market.

Sunday, 24th – 'Summer Serenade' at Eldroth Church at 7.00pm.

Wednesday 27th – Afternoon Church Fellowship - visit to the lovely garden of Mrs Grace Parker.

PARISH NOTICES

Church Flowers. Please add your name to the rota at the back of Church if you would like to put flowers in Church for a Sunday Service. The ladies who regularly see to the flowers would be happy to arrange them on your behalf.



Bentham Physiotherapy Clinic

Sports Injuries, Back Pain, Frozen Shoulder,
Acupuncture and more (see website)

Phone Chartered Physiotherapist

Marie Colyer MSc, MCSP

015242 62216

www.benthamphysio.co.uk

L. PRESTON & SONS

Proprietor: IAN PRESTON

**New & Used Car Sales
M.O.T. Testing & Repairs**

**TOWN HEAD GARAGE
AUSTWICK**

Telephone 015242 51391

HARRISON & CROSS LTD.

NICEIC APPROVED ELECTRICAL CONTRACTORS

**Unit 6, Sidings Industrial Estate, Settle
WHAT WE CAN DO FOR YOU!
THE ONE-STOP SHOP**

Complete and partial rewires, electrical checks on existing installations. Small appliance testing.

Televisions supplied and installed, aerials erected.

Visit our extensive electrical appliance showroom for chest freezers, larger fridges, washing machines, tumble dryers, dishwashers, cookers, microwaves and vacuum cleaners.

BRIGHTEN UP YOUR HOME

Our lighting showroom will give you all the latest ideas, we offer a free design service with installation if required.

Telephone: 01729 823423. Email: harrisoncross@cooptel.net

Thomas Redhead

Solid Fuel & LPG gas supplier

**All grades and sizes of coal,
every available smokeless fuel**

Netted Logs • Kindling • Bottled Gas all
delivered to your door.

QUALITY, RELIABILITY & CHOICE

Garden Compost now available

015242 41626 or 41212

Mark Watson

Home & Garden Maintenance



Digging, fencing, hedge trimming, mowing, paving, planting, power washing, spraying, strimming, turfing, gutters cleared. Loft insulating, pointing, rendering, painting.

No job too small, reasonable rates, estimates given.

**07759 680938 • 07759 680943
Low Bentham 015242 62038**



Paint - Colour Mixing - Wallpaper
Key Cutting - Locks
Timber - Woodcare Products
Plumbing - Gardening - Hardware
Bulbs - Electrical - Power Tools
Call in and See

Open Mon to Fri 8.30am – 5.30pm Sat 9.00am – 5.30pm
Ashfield Car Park, Settle BD24 9AA Tel: 01729 823002

www.settledi.com

Adderstone 3D Design

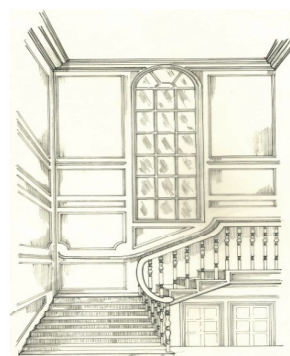

Planning Applications

A complete service for all your
planning requirements.

Including all forms and
plan layouts, elevations,
sections and perspectives.

Telephone: 07971 292156
helenbrocklehurst@hotmail.co.uk
www.adderstone3d.co.uk



**Now open Sundays
12 noon to 4pm**

ageUK
NORTH CRAVEN

*Advice and information for
older people and their carers*

CHEAPSIDE, SETTLE BD24 9EW

Tel: 01729 823066

Registered Charity number: 1141867

Clapham cum Newby Parish Council News

The Parish Council met on 26th April and 24th May

At the Annual Meeting of the Parish Council, Colin Price and John Dawson were re-appointed as chairman and vice-chairman respectively.

The council has completed the first stage of its audit of account and procedures for 2015-16. Local residents will be able to inspect the accounts and related documents between Monday, 6th June and Friday, 15th July. More details can be found on a notice soon to be displayed on the parish council notice board and webpage. Alternatively please contact the parish clerk if you would like to find out more (contact details are below).

Approximately 30 people came to see the beacon being lit at Bowland Knotts to celebrate the Queens 90th birthday. Councillor Kay was thanked for constructing the beacon which was quite a spectacular sight.

The parish council is recruiting a new parish caretaker. Councillor Dawson has been in discussions with several candidates and hopefully a new caretaker will be in post soon.

The following planning applications were reviewed:

- C/18/142C full planning permission for erection of single storey extension to side elevation and reinstatement of fireplace to day room, 4 Gildersbank, Church Avenue, Clapham.
- C/18/173D/LB Listed building consent for internal alterations to property, including repair of existing windows, formation of new external openings, demolition and rebuilding of external store/wc, reinstatement of central staircase, extend basement and provision of glazed roof and door to rear to create draught lobby, Spindle Tree Cottage, 2 Gildersbank, Clapham.
- 18/2016/16906 Application for advertisement consent for one freestanding sign in carpark entrance and one freestanding steel wire sculpture to replace existing totem sign, Goat Gap Café, Henbusk Lane, Newby LA2 8HS.
- 18/2016/16930 Construction of a two bedroomed detached bungalow with off street parking, Greenways, Newby, Clapham, Lancaster LA2 8HS.

The following approvals were noted:

- 18/2016/16703 Alterations to Existing Café Elevations. Incorporation of Living Accommodation into Café Footprint, Ancillary to the Café (First Revision of Approved Application Reference 18/2016/16216), Henbusk Lane, Newby.
- 18/142B/LB Listed building consent for erection of single-storey extension to side elevation and reinstatement of one ground-floor fireplace in day room, 4 Gildersbank, Church Avenue, Clapham.
- 18/2016/16761 Two storey and single storey side extension to provide accommodation to replace demolished defective part of premises. Demolish two storey and single storey side extension and rear extensions, Birk Knott, Keasden Road to Birk Knott, Clapham.

The application has been refused:

- 18/2016/16738 The construction of three residential dwellings (two semi-detached and one detached) with associated access and landscaping, land south of Clapham bounded by Station Road, Clapham.

Westby Dairy
Robert and Janet Townson

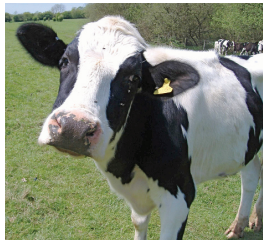

We deliver Milk, Cream and Eggs from our family dairy farm.

Our families have been producing milk for local delivery for generations, and now, along with the help of our son and daughters we are very proud to provide a great British tradition that is the doorstep milk delivery service!

We bottle milk from our own herd of cows for delivery to homes and businesses the very next morning.

Westby Hall Farm, Gisburn
Tel. 01200 445283

AIRE VALLEY

Glass

Job Done!

Manufacturers & Installers of Top Quality Made-to-Measure:

- ♦ Windows
- ♦ Doors
- ♦ Bespoke Conservatories
- ♦ Roofline
- ♦ Sliding Sash Windows
- ♦ Stable Doors
- ♦ Composite Doors by Rockdoor & Door-Stop International
- ♦ 14 different Woodgrains
- ♦ Farrow & Ball / RAL Chart Colour bonded PVCu
- ♦ Hardwood windows

FENSA

Registered Company



A Family-Run
Business Established
Over 25 Years

synseal



Bridge Road, Sutton-in-Craven
Keighley BD20 7ES

01535 634788

airevalleyglass@btconnect.com

Dalesview Business Centre
Old Road, Clapham LA2 8JH

015242 51705

www.airevalleyglass.co.uk



Volunteers spreading bark chippings around the play equipment

Clapham Playpark

Following the removal of the old shelter we are delighted to have secured a grant of £1,500 to go towards the £2,500 needed for a replacement shelter suitable for young children. This will complement a shelter that we installed last year primarily for use by teenagers. The children's shelter is one of the last few tasks needed to completely refurbish the playpark. The grant has come from the Roger Stott Community Grants scheme managed by the Yorkshire Dales Millennium Trust. The shelter should be installed by the summer holidays.

Towards the end of April we had a tidy-up and topped up the bark chippings. We've also started mowing the playpark every week or so (when time and weather coincide!).

*Don Gamble
Clapham Park Association
015242 51775*

Vernacular architecture courses

Boskins, binks and bressumers with

Alison Armstrong

Vernacular buildings are the attractive houses and barns, built of local stone, which contribute to the unique character of the Ingleborough Dales landscape, with its remote upland farms, small nucleated villages and isolated field barns. Built within the last 400 years by local farmers, such structures are a rich historical resource, though much under-used by historians. Documentary records are sparse and buildings are perhaps not greatly understood by nonspecialists.

An introduction to vernacular architecture will be running in Clapham on July 9th, and will show participants how buildings can provide evidence of the way people lived and worked. Participants will learn about observation and field-drawing, which can yield a wealth of information. No experience is necessary. This course will be followed on July 10th by an introduction to drawing vernacular buildings, also in Clapham. This course aims to improve recording skills in drawing-up building plans, elevations and details that form valuable records of our vernacular buildings. Participants will learn how observation, field-drawing, measuring skills and analysis can



yield a wealth of information. Some knowledge of vernacular architecture is necessary. These courses are part of Stories in Stone, a four-year programme of community and heritage projects that has been developed by the Ingleborough Dales Landscape Partnership with funding from the Heritage Lottery Fund. YDMT is the lead partner.

Both courses are £10 and you can find out more by visiting www.ydmt.org/getinvolved or contact Hannah.rose@ydmt.org, telephone 015242 51002.

Defibrillator Training

You may have noticed the new defibrillator on the wall of the CRO that Yorkshire Ambulance has provided for Clapham. If anyone is interested in finding out how to use it, please let me know. Once we have an idea of the number of folk interested, we can then arrange a suitable date/s.

It is a very simple device to use once you have been shown how to use it; it actually "talks you through the

process" when in use. Even if you are not sure whether knowing how to use it is for you, seeing how it works may change your mind!

In an emergency you would still call for an ambulance first, using the defibrillator buys time until the paramedics arrive to take over,

My contact details are dianeelphinstone@gmail.com or telephone 01524251813.

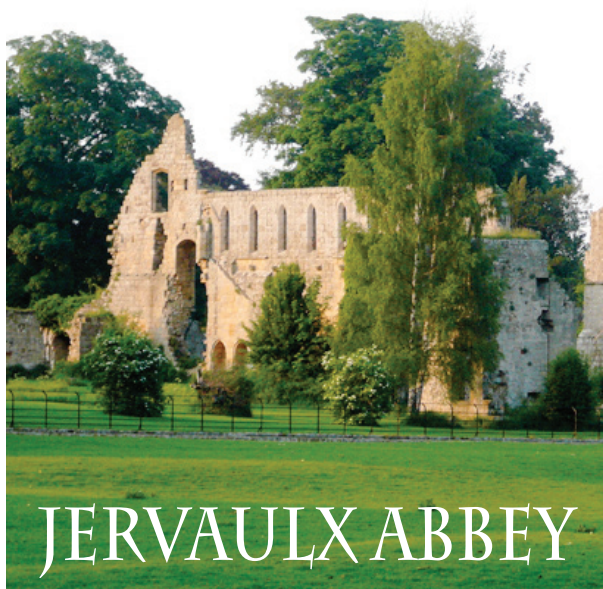

A MEMORABLE JOURNEY to JERVAULX ABBEY

One day in 2016 we enjoyed a drive to Pateley Bridge, it must have been spring as lots of daffodils were in bloom.

We travelled along the A65 to through Gargrave and took the left turn for Grassington, a lovely country road passing through pretty villages, travelling past the Angel Inn, in Hetton, known for its good food. Continuing along to Cracoe, turning right towards Grassington, staying on the A65 through Greenhow with wonderful views to be enjoyed from the top, I believe Greenhow is the highest village in Yorkshire. From the top we travelled downhill to Pateley Bridge, passing the remains of old lead mines (there is a car-parking place if you wish to stop and explore).

It is very worthwhile to visit Pateley Bridge, it has a super museum, lovely cafés and has, they say, the oldest sweet shop in England.

If time permits, return to the bridge, and take a right turn for Lofthouse and Ramsgill, passing through Ramsgill, passing the Yorke Arms. You can go on to How Stean Gorge (where once more there is a good café), or you can turn right and travel over the moors to Lofthouse, a lovely little village with attractive cottages.

If you wish to advertise in the Newsletter please contact Ray Hull at Park View, Church Ave, Clapham LA2 8EA
If you have an article or some interesting news that you would like to appear in the newsletter please email: hull365@btinternet.com or phone 51492.

The journey continues up a steep and winding road. At the top of the moor there is an extensive view of the distant North Yorkshire moors. There are dozens of lapwings, curlews and oystercatchers to be seen and heard which nest here every year, there are also grouse and occasionally partridge to be seen.

Leaving the moor, continue down past a reservoir and onto a signpost to Ellingstring, where we turn left on a single track road which passes an old duckpond at the crossroads. Here, follow the signs for Jervaulx Cistercian Abbey, which has a lovely tea room, and lovely wild flower grounds to enjoy.

The journey then continues through Middleham with its ancient castle. The road continues towards Leyburn, but, if you do not want to visit Leyburn, there is a left turn to Bainbridge and Hawes, passing Wensleydale Church which is well worth a visit. In Hawes there is the Cheese Factory with a visitor's centre. The journey concludes along the B6255, via Ingleton and back to Clapham to complete a brilliant day.













Rosie and Ray Hull

If you would like to tell us about your own memorable day out, then please contact Ray Hull 51492 or email hull365@btinternet.com and we will be pleased to include it in a future newsletter.

i**print** SHOP

From **DESIGN** to **PRINT** AND EVERYTHING IN-BETWEEN !

NOW WITH
ON-LINE ORDERING
& FREE
DELIVERY

 design/artwork	 colour printing	 digital copying	 business cards	 flyers	 instant photo prints
 posters & large photo prints	 lamination	 scanning to digital media	 document binding	 canvas printing	 business signs & cut vinyl decals

TEL: 01729 823990

THE REAL IN OR OUT

My old Uncle Bill was a very wise man who imparted his observations regarding farming on a regular basis. For example, it was he who taught me that the most difficult part of breaking (training) a young dog is “learning to swear with a mouthful of fingers”.

A more appropriate one for the time of year is “it’s allus good to get the cattle inside for winter but it is even better to get them out for the summer”.

There are not many jobs on a farm which give as much satisfaction as “letting the cows out”. The tension starts to build as the days lengthen and, hopefully, the weather improves enough to allow grass to grow in a rampant manner, which has not been the case this season. Cows can tell as the grazing season approaches as they start to lean over gates and against doors to voice their opinions. We often spread some fertilizer about two weeks beforehand on the pastures and I like to tell them when this has been done in order to whet their appetites.

The process takes a week or two at Bleak Bank as each animal goes through the crush to be wormed and is given a mineral bolus; this involves lots of flying cow muck and toes being stepped on by animals weighing up to half a ton, which can in turn lead to some questionable language.

By the end of May we are in full grazing mode with all cattle outside. This, along with the end of lambing time, is such a change in routine it represents something of a holiday, a bit like going to Blackpool but not as exciting or expensive. Winter housing buildings stand empty as they await the great spring clean which, at Bleak Bank, can happen as late as October – or just before the cows come back in. Cubicles need repairing as well as water troughs and doors, the list is endless.

Lambing time is now over (we still have one to lamb) the lambs are marked with our flock mark

and the sheep with singles have gone onto the sunny slopes of Ingleborough along with our neighbours’ flocks. Ingleborough is 3,500 acres of rough grazing which suits sheep with one lamb, they are able to produce enough milk for their baby and gain body condition. They also teach the lamb where to graze and live on the fell. This is handed down through the generations of sheep and each flock has its own patch despite there not being any fences, they are “hefted”.

We shepherd the mountain about twice a week looking for any issues, for example lambs who have lost their mother. Occasionally lambs fall part way down pot holes as they reach over to nibble young ash trees which tend to grow there. Historically, farmers would rescue their own lambs with the aid of neighbours. A rope would be tied around the neighbour or the Land Rover, depending on which weighed more, on the other end was some intrepid peasant on the mercy mission. The trick was to catch the lamb without startling it and sending it further down. For years we used a rope that was donated by some potholers who said it wasn’t fit for anything. Not a hard hat in sight. Nowadays we ring the Cave Rescue who are very professional and obliging and the whole thing is very dignified and safe. It usually involves a cup of tea and ginger biscuits, along with a donation.

Finally another Uncle Bill quote, “If you want a stable relationship – get a horse”.

John Dawson

Home Barn Foods

Outside catering for all events

Lucy Knowles

Fiach Cottage, Feizor, Austwick,
via Lancaster LA2 8DF

Telephone:

01729 825626 or 07738 922 524



Exhibition and Silent Auction

A chance to see and own an exciting variety of art from local, prominent and renowned artists.

Proceeds towards the refurbishment of the Drill Hall for the use of the Scouts and the whole community.

**Saturday, 25th June 2016
from 11am to 5pm.**

at the Drill Hall
Castleberg Lane, Settle.

Admission Free • Refreshments



The beacon at Bowland Knotts

People from Clapham, Keasden and Newby – and further afield, gathered at Bowland Knotts on the border with Lancashire to light a beacon on the Queen's 90th Birthday. It was lit by Colin Price, Chair of Clapham-cum-Newby Parish Council, as beacons came to life in the Ribble Valley.

Thanks to Gerald and Diane Kay for building the beacon and supplying the welcome champagne and glasses which were raised to Queen Elizabeth



Clapham's team of bellringers enjoying coffee and cake after ringing the bells in celebration of the Queen's 90th birthday. From left: Brenda Pearce, Jeanne Parry, Sue Manson, David Parry, Ken Pearce, Jacquie Twyford and Ron Wilson

More support from the National Park

Clapham Village Store has received a second grant from the Yorkshire Dales National Park Authority's Sustainable Development Fund, bringing the total from this fund to £9,102.

The funding has been used to buy new shelves and a vintage counter to finish off the new extension, while the previous grant went towards shop appliances. We are very grateful to the support shown by the National Park.

Hopefully you'll have seen the two new signs on the A65 promoting the shop to passing motorists. The shop also features on a new information panel at Clapham station promoting the Forest of Bowland and cycle and walking routes passing through Clapham, as well as local businesses. Our shop is an active member of the Plunkett Community Cooperative Network. Plunkett has given us much



Carl Lis, representing the Yorkshire Dales National Park Authority, handing over the cheque to shop volunteers and staff

support so it was great that we could host one of their pilot regional networking events in May. Thirty people attended from nine different groups and we were able to share information and experience with one another. Of course they all had to visit the shop before leaving the village!

Our second Annual General Meeting is on Tuesday, July 19th starting at 7.30pm in the Village Hall. Please come along and help us celebrate the continuing success of our community shop – all are welcome, though only shareholders can vote on any resolutions put forward. If you'd like to become a shareholder (or buy more shares) please contact:

Diane Elphinstone on 015242 51813 or dianeelphinstone@gmail.com, or visit www.claphamvillagestore.co.uk/be-a-shareholder to download our prospectus and application form, or pick up copies from the shop.

Don Gamble
Chair, Clapham Village Store

015242 51524
info@claphamvillagestore.co.uk
www.claphamvillagestore.co.uk



Clapham's award-winning VILLAGE STORE

the heart of our village

We are a community-owned shop, providing groceries, freshly baked bread and pastries. We offer a daily supply of fresh vegetables, meat and dairy, newspapers and lots more . .

Pop in and see our latest offers.

Telephone 015242 51524
info@claphamvillagestore.co.uk www.claphamvillagestore.co.uk and find us on facebook, Tweet to @ClaphamShop

Village Shop opening hours

Monday to Wednesday 8am–5.30pm;
Thursday 8am–7.00pm;
Friday 8am–5.30pm;
and Weekends 8am–3.30pm.

Please support your Village Shop

JAMES MARSHALL

Joiner & Carpenter

Established 1988

KEASDEN • CLAPHAM

Telephone 015242 51687

or Mobile 07813 117814



Peter Allen FLOOR COVERINGS LTD



**We offer commercial and domestic flooring.
Made to measure blinds. Selection of Rugs,
Bed and Mattresses.**

Full Amtico and Karndean showroom

**Opening times Monday – Friday 9am till 4.30pm
Saturday 10am till 12.30pm**

**Unit 2 Sowarth field industrial estate, Settle, BD24 9AF.
Email. info@peterallenflooring.co.uk**

Settle Chimney Sweep Services



**4 Craven Terrace
Settle BD24 9DB**

Supplier of pots, cowls & bird nets

Tel. 01729 823683

Mobile. 07815 285321



Jenny M Parker

Bsc (Hons), MCSP, HPC

Chartered Physiotherapist

**Specialising in the rehabilitation and
prevention of injury**



Mobile physiotherapy service offering comprehensive assessment and treatment of joint and spinal problems, sports injuries, respiratory and neurological conditions, all in the comfort of your own home. Cover for sporting events also available.

*Please call to discuss your requirements and to
book appointments.*

**Telephone: 015242 51049 Mobile:
07763 047160**

Septic tanks

Emptying & Maintenance

P J Richardson

Registered Waste Carrier No. NYK/642908

CLAPHAM, LANCASTER

Telephone 015242 51488

Mobile 07885 462 909

NATIONAL WATER WELL ENGINEERS



***Domestic & Agricultural
Water Well Drilling
Installation of Water Mains***

**Turnerford Cottage, Keasden, Clapham
LA2 8EX Tel. 015242 51013 or 07801 747632
email: waterwells@hotmail.co.uk www.
nationalwaterwellengineers.co.uk**

Knitting Needle Craft Haberdashery Sewing Card Making

Cottontail Crafts

VISIT OUR SHOP and WEBSITE

16 Duke Street, SETTLE BD24 9DN

www.cottontailcrafts.co.uk

sue@cottontailcrafts.co.uk

01729 822946

A Paradise for Crafters

Jewellery Ribbons Buttons Bows

Jewellery Ribbons Buttons Bows

This free Newsletter aims to keep everyone in Clapham, Keasden and Newby in touch with what is happening in our community. It does, however, cost a significant amount to produce, and advertising is a very necessary aid to the finances. An advert costs as little as £3.50 per issue. To advertise your products and services, please contact Ray Hull on 015242 51492 or by email below.

Articles, news and ideas please for the next issue
by **25th June, 2016** to

Chrissie Bell: ChrisHarte@aol.com
or Ray Hull: hull365@btinternet.com



The colourful stalls and patriotic bunting at Hall Garth for a celebration of the Queen's 90th birthday



Beckside Yarns & Needlecrafts

A Gallery full of fabulous yarns by:

NORO • COLINETTE
DEBBIE BLISS • ROWAN
BRIGANTIA • LOUISA HARDING
LANG • RYC • GEDIFRA

. . . . and many more

Help and advice always on hand
Call 015242 51122



BECKSIDE GALLERY CHURCH
AVENUE, CLAPHAM NORTH
YORKSHIRE LA2 8EA
www.becksideyarns.com
info@becksideyarns.com



Suppliers of top quality . . .

Traditional House Coal



Kiln Dried Firewood



Smokeless Fuel



Top Soil and
Mushroom Compost



Wood Heating Pellets

Call the office on
01524 812476

or visit

www.logsdirect.co.uk
to place an order



New Local LEISURE CENTRE

STACKSTEADS LEISURE CENTRE
TATTERTHORN LANE, INGLETON

Offering a 15 metre indoor swimming pool
with stunning views of Ingleborough,
a jacuzzi spa, a sauna and gymnasium.

● *Limited memberships available* ●

For more info phone 015242 41386 or e-mail
enquiries@stacksteadfarm.co.uk or visit
www.stacksteadfarm.co.uk

G. KAY BUILDERS Ltd.

- GENERAL BUILDING -

No job too small!

South View • Cross Haw Lane
Clapham • via Lancaster
LA2 8DZ

Mobile: 07805 874937

Home: 015242 51739



BRIDGE COTTAGE Bed & Breakfast

This charming 18th-century B&B with its sunny cottage garden is at the heart of Clapham, and has been extensively refurbished to reveal oak beams, window seats and slate floors. Enjoy a good selection of locally-sourced cooked breakfasts, homemade cake and biscuits.

Choose from three bedrooms: two doubles with ensuite showers, plus one twin/superking suite with ensuite bathroom and separate shower.

From £40 per person.

We are dog-friendly and are delighted to provide day care to our four-legged guests.

Station Road, Clapham LA2 8DP
Telephone 015242 51506
www.bridgecottageclapham.co.uk

A NIGHT TO REMEMBER with ALAN BENNETT



From left, Sue Manson, Sue Mann, Alan Bennett and Liz Mason

It was a brilliant idea borne out of the chagrin of Clapham church warden Liz Mason. She read in her daily newspaper that national treasure Alan Bennett thought that his village hall would not show any of his films.

He was of course referring to his latest national hit – *The Lady in the Van*, made into a film starring Dame Maggie Smith, and charting the tale of an eccentric woman who lived outside the playwright and author's North London home for 15 years.

Liz told him straight that the church would love to host an evening with his film – and how about putting it on in St James to allow a larger audience. Alan then kindly volunteered to introduce it.

Fast forward through several months of intense planning, involving Sue Manson and Tramps – the voluntary mobile cinema service – plus the amazing team that regularly bakes and organises refreshments, and the night of the showing in April arrived.

Tickets sold out in one morning so the church was packed, even the 'limited view' pews were taken. With gentle evening sun filtering through into the nave, there was a hum of excitement as Alan made his way up on to the makeshift dais, with its wooden throne and protective enclosure. "I feel as if I'm in the dock," he joked.

He then described how the film came about and how the facts presented were entirely true. The location was Gloucester Crescent, Camden –

his home from 1969. Mary Shepherd and her van had become an everyday sight, eventually arriving outside Alan's after 10 years of working her way down the street. It was after she was issued with a movement order that he invited her on to his drive, "thinking it would be three months".

It turned out, he said with a wry smile, that she was "on the edge of my vision for 15 years." Despite the ups and downs of their relationship, he insisted she did not impinge on his life. This was a word leapt upon by Dame Maggie, he revealed. "She never let me forget that I had used that word."

"Impinge! Impinge, she kept saying, and I said, yes, Miss Shepherd was dirty and smelly but she didn't impinge."

The delighted audience roared with laughter at this and the subsequent series of hilarious and charming anecdotes. It is easy to see why this most famous of Yorkshiremen has entered the nation's hearts. He speaks with such modesty and warmth, his self-effacing ramblings suddenly switching to sharp, true-life observations.

"If the film has a point," he said, "it is about fairness, tolerance and helping the less fortunate."

Around £1,500 was raised that evening for St James, Tramps and the Village Hall. Clapham thanks Alan. The wider world may have been amazed by your kindness for all those years. The locals know better.

Isobel Palmer

Wildlife in Clapham

The great grey shrike is about the same size as a Blackbird with striking clean cut black, grey and white plumage and it also has a long black mask through the eyes. It is a winter visitor to this country from Europe and Scandinavia. Most are seen along the east coast but some do make it over to the west coast, and some establish winter territories at favoured areas such as Stocks Reservoir, where one returned for three consecutive winters about ten years ago. The great grey shrike is also known as the butcher bird, when its food is plentiful such as small birds, small mammals and beetles it will impale them on to hawthorn spikes and store it until it is ready to eat it.

One was seen on Newby Moor near the old Little Chef on 17th April. This bird would have been migrating back to Europe or Scandinavia from a wintering area elsewhere in this country. This is the second great grey shrike I have seen around the local area, the first one was seen near Meldingscale Farm – Feb 2000.

The first swallows to arrive back were seen near Crina Bottom Farm and also Nutta Farm on the 3rd April. Alan Price reported to me that he saw two swallows and two house martins at Keasden on the 13th April.

One Osprey was seen by Rob Garnett flying north over the Bowland hills on the 7th April. Ospreys are now being seen more regularly during the migration season as there are several pairs now breeding in northern England.

Chris Hart has been seeing up to seven dotterels on Ingleborough regularly between the 1st May and 16th May.

A tree sparrow was found at Clapham Station on the 9th April. It then flew down in to the back garden of River Bank Cottage and I did not see it again. This is a new species of bird for the Clapham



Great grey shrike – Lanius excubitor

area. The nearest breeding areas for tree sparrows are around Bentham and there is a small population near Long Preston.

Other Summer visitors to arrive back were two Wheatears at Crina Bottom Farm on 3rd April, Chiffchaff at Ingleborough Hall on 31st March, eight willow warblers were seen and heard singing around the local area on 3rd April, two Blackcaps were heard singing at Ingleborough hall on 14th April, one male whinchat was seen at Crook Beck on 1st May and one little egret flew over Newby Moor on 2nd May, this is the fourth to be seen around the local area in five years. Only one cuckoo was heard calling from the Keasden area on the 14th May.

*Tim Hutchinson
Smithy Cottage*

Caretaker wanted

For Holiday Cottage in Austwick

(Sleeps 5) Entrance Porch, Hall, Toilet/Handbasin with cushion floor, Lounge/Dining Room with Living Flame gas fire, Kitchen with tiled floor, micro-wave oven, electric cooker, fridge, freezer. Three bedrooms, (1 double, 1 twin, 1 single). Bathroom with cushion floor. Fitted carpets. Gas central heating. (Gardener employed and key collection arranged).

**Tel: 01274 673642 day – 01274 883533 evening
mobile: 07731 191358**

ANGELA CROMPTON, BRADFORD

KEVIN CHADWICK

Agricultural Engineer



**On-Site Welding
Farm Buildings etc.
4x4 Repairs and
Plant Repairs**

**UNIT 1, DALES VIEW
OLD ROAD
CLAPHAM LA2 8JH
Telephone 07779 081388**

