

# CLAPHAM & DISTRICT NEWSLETTER

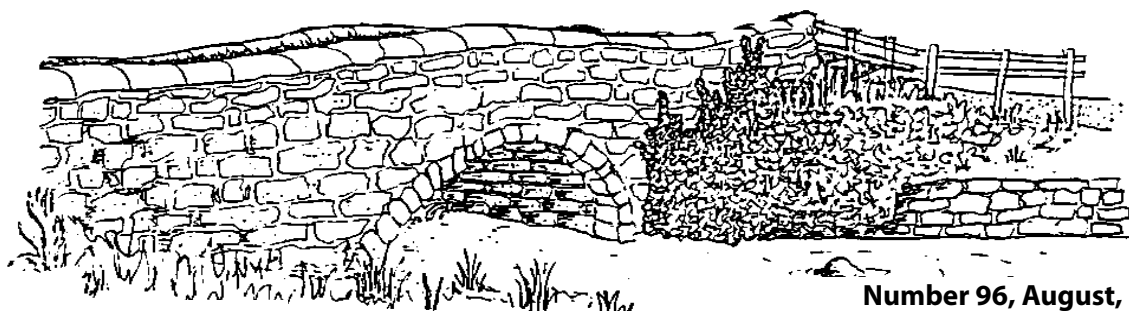

Number 96, August, 2015

## And the Sun Shone . . . .

The big question in everyone's minds in the build up to the Street Fair is 'Will it be fine?' We can control the details such as how many stalls, applying for the road closure, having a St John's Ambulance presence which we hope we won't need to use and booking the entertainment among other things. However, we can't make the sun shine.

Well, on July 25th all those hopes were granted when, not only did the sun shine, but it wasn't too hot, too cold or too windy. It did rain – but very kindly waited until we were all packing away. Apart from the weather there were many highlights in the day. First of all, the amazing variety of stalls, not only 10 from the church but 14 other organisations raising funds for their own good causes.

One thing we often lose sight of at the Street Fair is just how many people will benefit from the funds raised on the day, both large and small.

The range of entertainment was also appreciated by those present. Once again the Classic Cars turned out in all their finery and variety including, among

others, a vintage red Rolls Royce, a Model T Ford and a Jensen Interceptor.

For music, we enjoyed the Juke Box Junkies from Austwick whose 70s tunes started things off with a swing, then the Oak Quintet gave us some great jazz. Finally, we welcomed Crook Morris Dancers from Kendal to the Street Fair for the first time.

Added to all of this the Cave Rescue Organisation's climbing wall was obviously popular once again, the children's tent run by Bethel Chapel provided lots of fun and produced many painted faces and we all loved those tiny sheep from Greenlands Farm Village.

The climax of the day was, as ever, the Duck Race. The Village Hall sold a record number of ducks but, would you credit it, the winner was still yellow!

Finally, everyone at Saint James Church would like to thank all of those who contributed to the day in any way. Without the involvement of the whole community there would not be a Street Fair.

*Sue Mann*



*Stalls galore and a grand turnout*

# Beckside Yarns & Needlecrafts

A Gallery full of fabulous yarns by:

NORRO • COLINETTE  
DEBBIE BLISS • ROWAN  
BRIGANTIA • LOUISA HARDING  
LANG • RYC • GEDIFRA  
... and many more

Help and advice always on hand  
Call 015242 51122

BECKSIDE GALLERY  
CHURCH AVENUE, CLAPHAM  
NORTH YORKSHIRE LA2 8EA

[www.becksideyarns.com](http://www.becksideyarns.com)  
[info@becksideyarns.com](mailto:info@becksideyarns.com)



Suppliers of top quality . . .

Traditional House Coal

Kiln Dried Firewood

Smokeless Fuel

Top Soil and  
Mushroom Compost

Wood Heating Pellets

Call the office on  
01524 812476

or visit

[www.logsdirect.co.uk](http://www.logsdirect.co.uk)  
to place an order



## KEVIN CHADWICK

*Agricultural Engineer*



On-Site Welding  
Farm Buildings etc.  
4x4 Repairs and  
Plant Repairs

UNIT 1, DALES VIEW  
OLD ROAD  
CLAPHAM LA2 8JH

Telephone 07779 081388



## G. KAY BUILDERS Ltd.

- GENERAL BUILDING -

*No job too small!*

South View • Cross Haw Lane  
Clapham • via Lancaster  
LA2 8DZ

Mobile: 07805 874937  
Home: 015242 51739



## BRIDGE COTTAGE

### Bed & Breakfast

This charming cottage B&B is at the heart of the village of Clapham and overlooks the beck. It has been extensively refurbished to reveal oak beams, window seats and slate floors. Enjoy a locally-sourced full Yorkshire breakfast in the cosy dining room, then relax in front of the fire at night.

Choose from three bedrooms: two doubles with ensuite showers, plus one twin/superking suite which has an ensuite bathroom and separate shower.

We are dog-friendly and are delighted to provide day care to our four-legged guests.

Station Road, Clapham LA2 8DP  
Telephone 015242 51506  
[www.bridgecottageclapham.co.uk](http://www.bridgecottageclapham.co.uk)

## CHURCH NEWS

*The Vicar writes . . .*

Repay no one evil for evil, but give thought to do what is honourable in the sight of all . . . if your enemy is hungry, feed him; if he is thirsty, give him something to drink; for by so doing you will heap burning coals on his head' . . .

'Do not be overcome by evil, but overcome evil with good'

*Romans 12:17,20,21*

Over the years I have taken a number of holiday Chaplaincies for the Intercontinental Church Society (ICS), and at the end of the year I'll be helping in Zermatt where the English speaking Church has been present for 150 years. ICS has been involved in many areas of Europe and beyond, enabling English speaking Churches to be established. I found this article in their current magazine which is written by the Chaplain at Holy Trinity Church, Brussels, and I thought it totally appropriate for the world of today and also remembering 100 years ago.

Edith Cavell, known in the UK as a First World War heroine, is just as well known, perhaps better known in Belgium, as a pioneer of modern nursing. She was shot for treason for assisting the escape of British and other soldiers from Belgium (on 12th October 1915).

There is a plaque in her memory in Holy Trinity, Brussels, whose chaplain, when the church was called Christ Church, visited her the night before her execution. Her most famous words are inscribed on her statue in St Martin Place, London: 'Patriotism', she said, 'is not enough. I must have no hatred or bitterness for anyone'. That might be an easy enough thing to say in ordinary circumstances; but in time of war, when you have spent ten weeks in prison under threat of death for something that you believed passionately had been right? But those were not her only circumstance. The full quotation begins 'Standing in the light of God and eternity'. Whatever else was happening, that was where she stood.

Her patriotism was not in doubt though it was exploited in British propaganda after her death; but what shone through here was a conviction that what she thought, said and did were done before God, whom she would have to face.

These words are written against the backdrop of increasing persecution of faithful Christians in many parts of the world, and even increasingly difficult for Christians to bear witness in the West.

As they suffer appallingly for standing in the light of God and as many of us face incomparably fewer

problems, will we hear Paul's words with which this piece opened and follow Cavell's example, seeking 'to love and serve all, in the light of God and eternity'.

*Blessings to you all*

*Ian*

### Church Services in August

**Sunday, 9th** – 10.30 am Holy Communion and Baptism at Austwick. 11.00 am Holy Communion at Clapham. 2.00 pm Holy Communion at Keasden. 6.30 pm Holy Communion Austwick

**Sunday, 16th** – 9.30 am Holy Communion at Austwick. 11.00 am Holy Communion at Clapham 6.45 pm Evensong at Keasden. 7.00 pm Evensong at Eldroth

**Sunday, 23rd** – 9.30 am Holy Communion at Austwick. 11.00 am Holy Communion at Clapham. 2.00 pm Evensong at Keasden. 7.00 pm Church in the Pub at the New Inn, Clapham.

**Sunday, 30th** – 10.30 am United Service at Keasden

Holy Communion is held in Austwick Church every Wednesday at 10.30 am

### Looking Ahead

**Wednesday, 16 September** – 'How to Grow the Church Today' – a special evening for all our Deanery and Churches with Revd Canon Robin Gamble (Diocesan Outreach and Church Growth Officer) at Settle Parish Church 7.00 pm – 9.00 pm

**Sunday, 20 September** – Harvest Service at Keasden at 6.45 pm

**Sunday, 27 September** – Harvest Service at Austwick at 9.30 am and Supper and Auction in the Parish Hall in the evening

---

### Christian Aid Week

Our house to house collection this year was £811.75. This represents the many hours spent by kindly volunteers delivering and collecting the envelopes, often to the more remote dwellings of Keasden and Newby. Thank you to everyone whose generosity made the gift possible. Thanks also to Ron Wilson our treasurer who saw it correct and on its way.

---

### Sponsored Cycle Ride

The Vicar will be cycling the Hadrian's Wall Coast to Coast route (174 miles) on 13/14 August – if you would like to sponsor his efforts, please sign the form in Church or see him personally.

## L. PRESTON & SONS

Proprietor: IAN PRESTON

**New & Used Car Sales  
M.O.T. Testing & Repairs**

**TOWN HEAD GARAGE  
AUSTWICK**

Telephone 015242 51391

## Village Shop opening hours

From Monday, 1st June they will be:

Monday to Wednesday 8am–5.30pm;

Thursday 8am–7pm;

Friday 8am–6pm;

and

Weekends 8am–3.30pm.

**Please support your Village Shop**

## HARRISON & CROSS LTD.

NICEIC APPROVED ELECTRICAL CONTRACTORS

**Unit 6, Sidings Industrial Estate, Settle  
WHAT WE CAN DO FOR YOU!**

**THE ONE-STOP SHOP**

Complete and partial rewires, electrical checks on existing installations. Small appliance testing.

Televisions supplied and installed, aerials erected.

Visit our extensive electrical appliance showroom for Chest Freezers, Larder Fridges, Washing Machines, Tumble Dryers, Dishwashers, Cookers, Microwaves and Vacuum Cleaners.

**BRIGHTEN UP YOUR HOME**

Our lighting showroom will give you all the latest ideas, we offer a free design service with installation if required.

Telephone: 01729 823423. Email: harrisoncross@cooptel.net

# JAMES MARSHALL

*Joiner & Carpenter*



Established 1988

**KEASDEN • CLAPHAM**

**Telephone 015242 51687**

**or Mobile 07813 117814**

## Thomas Redhead

*Solid Fuel & LPG gas supplier*

**All grades and sizes of coal,  
every available smokeless fuel**

Netted Logs • Kindling • Bottled Gas  
all delivered to your door

**QUALITY, RELIABILITY & CHOICE**

**Garden Compost now available**

**015242 41626 or 41212**



**Paint - Colour Mixing - Wallpaper**

**Key Cutting - Locks**

**Timber - Woodcare Products**

**Plumbing - Gardening - Hardware**

**Bulbs - Electrical - Power Tools**

**Call in and See**

Open Mon to Fri 8.30am - 5.30pm Sat 9.00am - 5.30pm

Ashfield Car Park Settle BD24 9AA Tel: 01729 823002

**www.settlediyy.com**

## Mark Watson

**Home & Garden Maintenance**



Digging, fencing, hedge trimming, mowing,  
paving, planting, power washing, spraying,  
strimming, turfing, gutters cleared.

Loft insulating, pointing, rendering, painting.

No job too small, reasonable rates,  
estimates given.

**07759 680938 • 07759 680943**

**Low Bentham 015242 62038**



**Now open Sundays  
11am to 4pm**

**NORTH CRAVEN**

*Advice and information for  
older people and their carers*

**CHEAPSIDE, SETTLE BD24 9EW**

**Tel: 01729 823066 or 01729 825669**

Registered Charity number: 700054



# Tribute to Ernest Coultherd (Ned – Ernie)

Ernie was born on the 24th April, 1946 at Fountain House, Clapham – his father was Edward, and his mother is Margaret. Tommy is Ernie's younger brother and friend.

Ernie went to Clapham School and then to Ingleton, but as a farmer's son farming was very much in his blood. As a ten year old lad he was often seen in Station Road sweeping up the leaves to provide bedding for the animals.

On leaving school Ernie began working on the farm and there he met Barbara. She was an Austwick girl who began working in the Clapham shop. Barbara's brother, Brian was a big friend of Ernie. Barbara was soon being given lifts home to Austwick. They started 'courting' when Barbara was 16. They enjoyed going to the local dances, and they were married in Austwick Church on the 21st October, 1970.

Sally was born in 1973 and Simon in 1975 and they moved soon after into Beck Cottage.

On the 6th October 2004 Ernie and Barbara moved to their present home in Settle and Simon and Ruth moved into Beck Cottage, but like all farmers, Ernie did not retire. He and Simon continued working the farm together, Ernie never lost his love for Home Farm.

Ernie contributed much to the local Clapham community, until recently helping his brother Tommy with the milk round. He helped the Bradford Pothole Club during the Gaping Gill Weeks.

He was truly one of the characters and personalities of Clapham Village. Four generations of Coultherds worked and lived in Clapham for over 100 years.

He was very much involved with Settle Rotary and he invited me along as guest speaker soon after I arrived here as Vicar – my theme being of course 'A View of the RAF'.

He loved dominoes, and played for the Settle Conservative Club, he was always at the Eldroth Harvest Dominoes, I noticed his expertise and he often had the highest score.

He also loved his holidays and travel. When the children were young they always had a week away. They began going abroad, and over the past years Ernie and Barbara have been to Spain, and far beyond to China, Russia, Kenya, America and have been on some lovely cruises. In April to celebrate Ernie's birthday they had a lovely week together in Jersey.

Ernest was a loving husband and he and Barbara had nearly 45 years of happiness. They worked



together for their home and family and he was especially proud of Sally and her family John and Luke, and also of Simon and Ruth, Zara and Ben. He loved his family . . . yes, his priorities were certainly in the right order!

I met Ernie soon after arriving as Vicar in 2004, in fact Ben was the first baby I baptized on 2nd May. Virtually every time I saw Ernie, he would wave, or we would have a quick chat about life, the farm, the village or the Rotary. He was a genuine and caring man – he cared about his mother, Margaret and he was so pleased when they found the lovely nursing home at Hornby for her. He was close to his brother Tommy and he was indeed a true friend to all of us here today.

Our reading is perfect for someone who was born on possibly the best day of the year, the 24th April 1946 which was Easter Sunday, the day of resurrection and new life, new hope: death had been conquered. Jesus gave us those great words of John 14 – so meaningful whenever we lose a loved one.

"In my Father's house are many mansions, and I go to prepare a place for you, and I am the way". Yes today we thank God for Ernie, a truly good man, who is at peace, in the place prepared for him by our Lord.

*Revd. Ian Greenhalgh*

# AIRE VALLEY

## Glass

## Job Done!

**Manufacturers & Installers of Top Quality Made-to-Measure:**

- ♦ Windows
- ♦ Doors
- ♦ Bespoke Conservatories
- ♦ Roofline
- ♦ Sliding Sash Windows
- ♦ Stable Doors
- ♦ Composite Doors by Rockdoor & Door-Stop International
- ♦ 14 different Woodgrains
- ♦ Farrow & Ball / RAL Chart Colour bonded PVCu
- ♦ Hardwood windows

**FENSA**

Registered Company



**A Family-Run  
Business Established  
Over 25 Years**

synseal

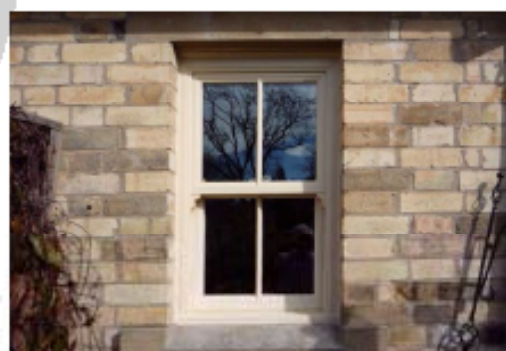

Bridge Road, Sutton-in-Craven  
Keighley BD20 7ES

**01535 634788**

[airevalleyglass@btconnect.com](mailto:airevalleyglass@btconnect.com)

Dalesview Business Centre  
Old Road, Clapham LA2 8JH

**015242 51705**

[www.airevalleyglass.co.uk](http://www.airevalleyglass.co.uk)

## Community Orchard Group

**Fun (mostly), fruitful** (if not quite in the way we intended), but now finishing . . .

It is the Clapham Community Orchard experiment we're talking about. What began just over four years ago with the planting of fruit bushes and trees in willing gardens, went on to declare itself under a jazzy stall banner as a fruit-share outlet, then metamorphosed, with sleight of patchwork, into a food-share corner, as potatoes and lettuces began to out-number blackcurrants or strawberries.

Last year it shrank to the dimensions of a plastic bring and take box. Keeping company with all these changes has given us plenty to think about, laugh about, be glad about – even when we weren't enjoying rain dripping down the back of our necks on an all-too-normal Yorkshire Saturday. But we have tried, at each turn, to be realistic and now, with the re-creation of our village shop meeting Clapham's food needs in a different way, we feel it's time to exit quietly. We do so with a huge sense of warmth given us by the generosity of many people. So now it is time for us to call a halt – but our fruit bushes and trees in their separate gardens are only just beginning.

*Clapham Community Orchard Group*



## Clapham Village Store

*the heart of our village*

We are a community-owned shop, providing groceries, freshly baked bread and pastries. We offer a daily supply of fresh vegetables, meat and dairy, newspapers and lots more . . .

**Pop in and see our latest offers.**

**Tel. 015242 51524**

**info@claphamvillagestore.co.uk**

**www.claphamvillagestore.co.uk**

**and find us on**

**facebook, Tweet to @ClaphamShop**

## Thank-you, but who are you?

In the October 2014 issue of this Newsletter I wrote a short article about the fundraising partnership between Taylors of Harrogate and the Dry Stone Walling Association (DSWA) based at Crooklands, Cumbria. I explained that some of the Yorkshire Tea packaging barcodes are worth 25p to the DSWA and others up to £1, depending on which item they are cut from.

A very kind person put an envelope full of barcodes through our letterbox in early July but the donor did not identify him or herself. Thank-you, kind person. Please let me know who you are. The DSWA is most grateful.

The DSWA is a small one with a wide horizon. It supports professional, amateur and trainee wallers; it sets standards of workmanship and trains instructors and examiners; it has links with voluntary organisations, plus agricultural and rural industries; its public face can be seen through the activities of twenty regional branches covering England, Scotland and Wales; it builds links with walling associations and heritage groups all over the world where dry stonework, workmen and women have a history and a future.

*Ann Stewart 51118 or  
ann@eggshell2.demon.co.uk*

## Clapham Playpark

We now have a team of volunteers available to mow the playpark on a weekly basis, though if you'd like to help, or have offered to help in principle but haven't been able to give a definite time yet, please contact Don on 51775.

We had hoped that the new shelter would have been installed by now but the company we've placed an order with have been very busy. Hopefully it will be installed by the end of August.

*Tracey Bilton (015242 51856)  
Clapham Park Association*

## Autumn Lectures

Ten well illustrated talks by Kevin Illingworth BA on the traditional buildings of the North-west and the West Riding of Yorkshire. Content will include the development of traditional farmhouses and farm buildings, building materials, including materials used.

The lectures will be held in Clapham School commencing Tuesday, 15th September at 7.15 pm. Fee £50. Enquiries on 015242 51324.



## Pet Rescue Quiz Night

Many thanks to everyone who came to the Quiz Night held recently in the Village Hall in aid of Bentham and District Pet Rescue which raised £363 for the charity.

There were many people were involved in the organisation of the event and we would like to thank them all for the hours of work they put in to making it a success. Thanks go to Clapham Village Store for selling the tickets on our behalf. Special thanks also to Kristen and Rob Bullock for shopping, cooking and serving the delicious main course which was very well received. Thanks also to Ray Hull for printing the tickets.

We are also very grateful to all the volunteers and supporters of Bentham Pet Rescue who kindly donated all of the puddings on the night and prizes for the raffle. Thanks to Richard and Justina Sexton for the smooth running of the bar and also thank Sheila Maywood who came to the hall especially to do the washing up.

Our final and most heartfelt thanks go to the man who makes all of this possible, our quizmaster Stuart Marshall for all the time and effort he put into preparing and delivering yet another one of his excellent puzzles, assisted as always by his lovely wife Barbara, and they ask for nothing in return except for their supper!

Stuart entertained the audience for three hours with his usual wit and light-hearted sense of humour. We have had so many compliments from people who said they had had a thoroughly enjoyable evening.

*Sally Dewhirst*

## Settle Photographic Group

are holding an exhibition in  
CLAPHAM VILLAGE HALL  
at the Bank Holiday weekend,  
Saturday to Monday from 11am to 5pm

**Refreshments will be available.**

Admission free.



You are invited to join us at our  
**COFFEE MORNING**  
at Arbutus House, Riverside, Clapham  
on Friday, 25th September  
10am to 12 noon

Raffle, Cake Stall, Books, etc.

To offer help please contact  
Liz (51319) or Jackie (51240)

## Westby Dairy

**Robert and Janet Townson**



**We deliver Milk, Cream and Eggs from our family dairy farm.**

*Our families have been producing milk for local delivery for generations, and now, along with the help of our son and daughters we are very proud to provide a great British tradition that is the doorstep milk delivery service!*

**We bottle milk from our own herd of cows for delivery to homes and businesses the very next morning.**

**Westby Hall Farm, Gisburn  
Tel. 01200 445283**

## Adderstone 3D Design

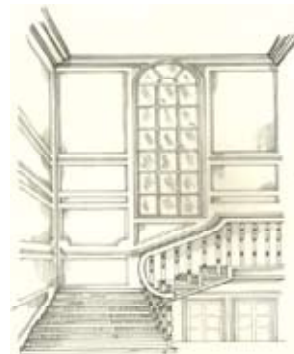

### Planning Applications

**A complete service for all your planning requirements.**

Including all Forms and  
Plan Layouts, Elevations,  
Sections and Perspectives.

**Telephone: 07971 292156  
helenbrocklehurst@hotmail.co.uk  
www.adderstone3d.co.uk**



# Parish Council News

The parish council met on 23rd June and 28th July

The owner of the former Dalesview Garage site, McConnell Homes Ltd, has submitted detailed planning drawings on the appearance, means of access, landscaping, layout etc to Craven District Council (CDC). This is the final stage in the planning application process. Craven District Council planning committee will review the application on 3rd August. Cllr Sheridan will attend the meeting to put the parish council's view that the development should not have an electronic gate at its entrance.

The parish council is investigating the possibility of obtaining a community defibrillator. We need to recruit a group of volunteers to be trained in CPR. If you are interested then please contact the Clerk, Gillian Muir, on [claphamclerk@btinternet.com](mailto:claphamclerk@btinternet.com) or 51775. The proposal to have a defibrillator has evolved from the development of a Community Emergency Plan. The first draft of the plan should be ready in the next few weeks.

The parish council has received a complaint about the amount of dog fouling in Clapham especially around the waterfall area. The majority of dog owners are very considerate but the council would like to remind everyone to make use of the dog poo bins in the village. These are situated at the entrance to the tunnels, at the bridge on Main Street and on Cross Haw Lane near the village hall.

Grant monies have been allocated to the council for general maintenance tasks in the Forest of Bowland area of the parish. To date, drainage improvement works have been carried out on the roadside at Keasden notice board and Keasden Church. A new notice board will soon be installed near Clapham Station. If you have any ideas that you would like the parish council to consider, please contact the Clerk.

## **The following planning applications were considered:**

- 18/2015/16014 Application to discharge condition no.3 of planning approval referenced 18/2014/15065 concerning materials to be used in external finish, Old Manor House, the Green, Clapham

## **The following approvals were noted:**

- 18/2015/15563 Proposal to form new opening in stone wall within curtilage of Grade II listed building, Flying Horseshoe Caravan Site, Station

Road, Clapham.

- 18/2015/15609 Conversion and extension of existing garage/former barn to form a new dwelling, Tenter Hill House, Henbusk Lane, Clapham.
- 18/2015/15691 tree works at Flying Horseshoe Caravan Site, Clapham Station.
- 18/2015/15669 Single storey extension to front elevation, Dovenanter Cottages, Keasden Road, Clapham.
- 18/2015/15702 Erection of cabinet to house electronic telecommunications equipment, Reebys Lane, Keasden.
- 18/2015/15771 Creation of new door opening, new oil tank and satellite dish and single storey garage to one side, Inglenook, Green Close, Clapham
- 18/2015/15791 Conversion of redundant agricultural barn to B1 workspace with ancillary living accommodation, Bence Barn, Keasden Road, Clapham

## **The following application was withdrawn:**

- 18/2015/15834 Outline application for proposed detached dwelling, Greenways, Newby

The following proposals are still pending:

- C/18/65P: full planning permission for erection of two bedroomed bungalow, Old Mason's Yard, Clapham
- C/18/615C full planning permission for replacement of uPVC glass conservatory with stone built and natural slate roofed lean-to garden room, Deighton House, Riverside, Clapham
- 18/2015/15634: Reserved matters application (appearance, scale and landscaping) pursuant of outline planning application 18/2012/13161, Former Dalesview Garage site, Old road, Clapham

For more information on the work of the parish council please click on the 'parish council information' link at [www.claphamyorkshire.co.uk](http://www.claphamyorkshire.co.uk).

The parish council meets on the 4th Tuesday of each month (except December when it is 3rd Tuesday) and meetings take place in the Village Hall starting at 7.30pm. Everyone is welcome to attend.

Parish Clerk & Responsible Financial Officer Gillian Muir can be contacted by email: [claphamclerk@btinternet.com](mailto:claphamclerk@btinternet.com) or by phone 015242 51775.

# CLAPHAM CHURCH BI-CENTENARY

Many people are well aware that there has been a church in Clapham from at least 1160AD. There is a list of the village priests on the wall just inside the main (south) door of the church, telling us that the earliest known priest in the village was one Adam who served here at that time, less than 100 years after the Norman French conquered our country and ravaged the north of England. But nowhere in the church is there any mention of the fact that the nave, the larger part of the building, is 200 years old this year, or possibly last year.

In 1812 England was at war with Napoleon and France. The momentous battle of Waterloo was still 3 years in the future, a distant victory of which the English could only dream. In Clapham other less weighty matters also occupied the thoughts of the local gentry and landowners. They must have been talking among themselves for a year or more about the problem of their parish church. They agreed that it was far too small for their ever-growing population. Some felt that a larger, grander building was needed, not only to accommodate the faithful folk of Clapham parish but perhaps also to grace the country seat and sporting estate which old Oliver Farrer had in mind before he died in 1808.

So all the parishioners of Clapham, Newby, Austwick, Keasden and Eldroth, plus anyone with right or title to any pew or seat or stall in Clapham parish church, were invited ("summoned") to a consistory court to be held on Thursday 23rd July 1812. This special court was summoned by the Reverend George Markham, the Bishop of Chester's representative in the Archdeaconry of Richmond (which included Clapham at that time), to hear any objections to a proposal to give permission "... to remove and take away the present old roof of the said (Clapham) Church and to substitute and place another roof entirely new thereon ... "made of best deal timber and Ingleton slate. The interior was to be "well ceiled". It was further proposed "... to take down and rebuild the whole of the south wall and the range of pillars adjoining and such other parts of the body of the said Church as shall appear to be necessary and stand in need thereof and also to new pew the said Church and to empower and enable the said (Commissioners) to sell and dispose of the lead which at present covers the roof of the said Church in the best manner and for the most money that can be obtained for the same".

These Commissioners were among the great and the good of Clapham – James Farrer, James William Farrer, Oliver Farrer, the Reverend Thomas William Morley, Charles Ingleby, William King, William Ash, Robert Waddington, Thomas Foster, George Clapham, William Jacques and William Foster. Most

were major landowners in the parish, while William Ash was the schoolmaster and parish clerk.

They were instructed to use the proceeds of that sale to help pay for the alterations and to make other alterations to the building and seats to make it "regular and uniform throughout" and to execute the scheme.

The court was duly assembled on the Thursday appointed and the proposal was read out three times to the assembly. There were no objections. The proposal was thus agreed and the Bishop's representative, Rev. John Headlam, issued a faculty granting permission for the work to go ahead. This was signed off by the Deputy Diocesan Registrar Octavius Leefe with a note that the completed work had to be certified to the court by the Commissioners named above. So the whole process was publicised, approved, checked and bureaucratically controlled.

Just over two years later, on 18th October 1814, the 12 Commissioners were able to lay before the consistory court a certificate to the effect that "... the Body of the within mentioned Parish Church of Clapham hath been taken down and rebuilt and a roof intirely new substituted thereon the materials whereof consist of the best Deal Timber and Ingleton Slate and the inside of which is well ceiled and plastered, that the whole of such Church is now new pewed and seated so as to render the whole uniform and regular and that every other thing hath been done for which the said faculty was granted ... ". The work was finished, the church had been built anew.

In preparation for that great day the Clapham Vestry Meeting, predecessor to the Parish Church Council, had on 4 June 1814 appointed 6 Commissioners "... to allot and award ... "the seats in the grand new church building then nearing completion. These Commissioners were the parish clergy of Horton-in-Ribblesdale, Ingleton and Thornton together with William Bolland and John Peart of Settle and John Geldard of Rathmell. Clearly these were all trustworthy men who could be relied upon to be independent and fair in the allocation of the many new pews. They paid great heed to the status of each parishioner and his property. James Farrer, owner of a 'capital messuage' called Clapham Lodge was first on the list, allocated the pew in what was regarded as the best position, above the vicar's vestry. Other parishioners were ranked by name in an order of importance, the more lowly being awarded seats further from the altar.

This process of allocation seems to have taken some long time. One can imagine the arguments and negotiations that must have transpired before the list was finalised. On 12th January 1815 it was carefully numbered and written out on several large sheets of parchment, a precise record of every householder



in the parish with an indication of the size of his household and his social standing. Fastened to these sheets of parchment was another, a plan of the new nave showing every pew numbered to match the list. A Faculty of Confirmation was addressed by the Rev. George Markham to “ . . . all and singular Clerks and literate persons . . . ” on 10th March 1815 confirming that the original faculty of July 1812 had been carried out and that the seating allocation in the new church had been agreed and accepted.

The work was carried out “ . . . at the sole expense of the Parish, which as near as could be computed cost £3,134.7.4½ . . . ”. The cost was met by each household paying a weekly contribution, a self imposed land tax. And what did the parishioners get in return for two or three years’ extra taxation?

No record of the size of the old church seems to have survived. However, the present building bears traces which give some indication of the size of the old building when considered alongside a contemporary painting or drawing of it. The base of the tower is still partly enclosed by the west end of the old church and from this we know that the old nave was 28 feet (8.75 metres) wide outside and that the present octagonal columns now supporting the nave roof are planted squarely on top of the footings of the north and south walls of the old nave. The print shows that the old nave roof butted up against the east side of the tower at a height well below the belfry east window but that window opening is now mostly below the level of the roof which was built in 1812–14, showing that the roof was raised several feet at that time. The print shows the ridge of the roof of the old nave at the same

level as the top of the clock chamber window in the south side of the tower. Comparing these heights enables us to estimate the height of the roof before its level was raised as having been about 27 feet (8.25 metres). We can only estimate the length of the old church by comparing the length as shown on the old print with the unaltered height of the tower. This gives us a length of about 82.7 feet (25.21 metres).

These dimensions for the old church show that in the period 1812 to 1814 the nave was demolished and rebuilt 10 feet (3.04 metres) higher at 37.7 feet (11.5 metres) high, exactly twice as wide at 56 feet (17.07 metres) wide and, at 93 feet (28.4 metres) long, nearly 11 feet (3.3 metres) longer than the earlier one. Its footprint area was increased from 2,315 sq.ft. (215 sq.metres) to 5,208 sq.ft. (483.8 sq.metres) – an increase to 2¼ times the original footprint. This new, larger building was designed to accommodate the population of the entire old parish – there were few who did not attend in those days.

In May 1879 the parish of Austwick was created out of the ancient parish of Clapham, roughly halving the size of the community which used and financed the enlarged Clapham parish church building. In 1883 consideration was therefore given to the idea of demolishing the church again and rebuilding on a smaller scale but the cost, then estimated at £2,000, was thought to be beyond the parish purse. Instead, minor changes were made to the interior. In the 1890s and early decades of the 20th. century considerable support from members of the wider Farrer family enabled the building to be refurnished as it is today.

*Ken Pearce*



**i print SHOP**

20 Station Road • Settle  
North Yorkshire • BD24 9AA  
hello@iprintshop.co.uk  
Tel: 01729 823990



From Camera Memory Cards  
or USB sticks, also Video.  
Pictures or Film Scanned  
to Memory cards.

**NOW WITH  
PHOTOBOOTH  
SELF-SERVICE  
PHOTO  
PRINTING**

**OPENING HOURS**  
Monday - Friday 9.00am - 5.30pm  
Saturday 10.00am - 1.00pm

**FREE PARKING AT THE DOOR**



 **Bentham  
Physiotherapy  
Clinic**

Sports Injuries, Back Pain, Frozen Shoulder,  
Acupuncture and more (see website)  
Phone Chartered Physiotherapist  
**Marie Colyer MSc, MCSP**  
**015242 62216**  
[www.benthamphysio.co.uk](http://www.benthamphysio.co.uk)

**New Local  
LEISURE CENTRE**

**STACKSTEADS LEISURE CENTRE  
TATTERTHORN LANE, INGLETON**

Offering a 15 metre indoor swimming pool  
with stunning views of Ingleborough,  
a jacuzzi spa, a sauna and gymnasium.

● *Limited memberships available* ●

For more info phone 015242 41386 or  
e-mail [enquiries@stacksteadfarm.co.uk](mailto:enquiries@stacksteadfarm.co.uk)  
or visit [www.stacksteadfarm.co.uk](http://www.stacksteadfarm.co.uk)

## Clapham Village Hall

A BIG thank you to all who supported the Duck Race at the Street Fair. A record number of ducks were sold and jostled for space in the beck on a lovely sunny afternoon. We really do appreciate the support given to the Village Hall. This event is one of our biggest fund raisers and enables us to keep the hall and its facilities to the current high standard. We need to maintain the hall well to ensure it is an attractive venue not just for all the weekly meetings but for special events such as weddings, birthday parties, funeral teas, charity fund raisers etc.

Your support is welcome and valued. Thank you.

To enquire about a booking please contact Kathy Hall (015242 51232).

**Ann Stewart  
Dry Stone Walling**

Tel/Fax: 015242 51118  
e-mail: [ann@eggshell2.demon.co.uk](mailto:ann@eggshell2.demon.co.uk)

2 Eggshell Lane, Clapham  
Lancaster, North Yorkshire LA2 8EP

 Professional Member Dry Stone Walling Association

**Home Barn  
Foods**

*Outside catering for all events*

**Lucy Knowles**  
Fiach Cottage, Feizor, Austwick,  
via Lancaster LA2 8DF

**Telephone:**  
**01729 825626 or 07738 922 524**

If you wish to advertise in the Newsletter  
please contact:  
Ray Hull at  
Park View, Church Ave, Clapham LA2 8EA

If you have an article or some interesting  
news that you would like to appear in the  
newsletter please email or telephone .

[hull365@btinternet.com](mailto:hull365@btinternet.com)  
or phone 015242 51492

# A Post Office for the Village Store?

The shop is doing very well and is on target to achieve, if not exceed, the first year turnover target of £195,000. The last few weeks have been particularly good, partly because of the caravanners and other travellers. This seasonal trade is important but residents are the key to the shop being successful in the long term.

Our first annual general meeting, held on 1 July, was well attended and hopefully an enjoyable evening for all. Following reports from the chair, secretary and treasurer, the management committee stepped down and Keith Blondel, Marilyn Galpin and Jill Gates, along with four of the eleven founding members - Eddie Leggett, Sue Mann, Denise Wilson and me - stood for election. All were elected by the shareholders present.

During the meeting we had a discussion about our application to operate a post office counter in the shop. The only licence available to new operators such as Clapham Community Shop Ltd is for a Post Office Local. This licence requires operators to provide post office services whenever the shop is open, and operators only get commission on each transaction rather than a salary. Based on the performance of Clapham's previous post office, PO Ltd estimated that we would get commission of £2000 per year (compared to the previous £13,000 salary). Contracts are for a minimum of 12 months and six months' notice is required to pull out, so we would be committed to running the post office for at least 18 months. PO Ltd pays for the installation of its counter and equipment, as well as training for operators.

However, due to the delays caused by PO Ltd and uncertainty about whether we would be able to provide staff and volunteers to operate the counter, shareholders asked the management committee to carry out a community consultation to determine the current level of demand for a post office. Shareholders and most parishioners should already have received a questionnaire (reproduced on this page). It's also available from the shop or from our website. The deadline for responses is 7pm on Thursday 7 August. As it would be unreasonable to rely on volunteers to operate the post office counter, the management committee has told PO Ltd that the post office counter could only be open when paid staff are on duty (Monday to Friday 9am - 11.30am and 1 - 5pm; Saturday and Sunday 9am - 1pm). We have stipulated that PO Ltd should respond to this proposal by mid-August.

PO Ltd's response, together with the results of the survey, will be presented at a meeting in the village hall on Thursday 10 September starting at 6.30pm. All are welcome, and shareholders will vote on whether we continue with the post office application. If you have any questions relating to the post office please phone Denise on 015242 51104 or email [denise.wilson@hotmail.co.uk](mailto:denise.wilson@hotmail.co.uk).

If you'd like to become a shareholder please phone Eddie Leggett on 015242 51030, visit our website or pick up a prospectus from the shop. Shares are £10 each. You don't have to be a shareholder to tell us what you think about the shop, though. We need to know what you like and dislike, and what works and what doesn't, so please do let us know.

If you'd like to volunteer to help with a range of tasks for how ever much time you want then please pop into the shop and have a chat with Helen, the shop manager, on any weekday.

On behalf of the new management committee, thanks for your support and we look forward to helping the shop build on its great start.

*Don Gamble*

*Chair, Clapham Community Shop Ltd*

015242 51524

[info@claphamvillagestore.co.uk](mailto:info@claphamvillagestore.co.uk)

[www.claphamvillagestore.co.uk](http://www.claphamvillagestore.co.uk)

✂ —————

## **Clapham Community Shop Ltd.**

### **Post Office questionnaire**

1. On a scale of 1 to 5, how important do you think it is to have a Post Office in Clapham, where 1 is 'not important' and 5 is 'very important'?

☐ 1   ☐ 2   ☐ 3   ☐ 4   ☐ 5

2. How often do you use a Post Office?

☐ Daily                      ☐ A few times a week  
☐ Weekly                      ☐ A few times a week  
☐ Monthly                      ☐ Occasionally  
☐ Never

3. What Post Office Local services would you most likely use?

☐ Postage stamps\*                      ☐ Cash withdrawal\*  
☐ Sending parcels                      ☐ Personal banking  
☐ TV licence stamps                      ☐ Business banking  
☐ Council tax payment                      ☐ Benefits or pensions  
☐ Paying bills                      ☐ Travel insurance  
☐ Electricity stamps                      ☐ Foreign currency  
☐ ISAs

(\* The shop currently sells postage stamps and may, in the future, offer personal cash withdrawals).

4. Any comments? If you have any comments, please include them with this questionnaire and return them by 7pm on Thursday, 6th August to the Village Store or email: [info@claphamvillagestore.co.uk](mailto:info@claphamvillagestore.co.uk)

The above is a copy of the questionnaire that has been available recently in the shop. Thank you for taking the time to complete it.

## Newsholme & Son

(Established 1950)

*Electrical Engineers*

**STATION ROAD, CLAPHAM**

**Write or phone 015242 51383**

Domestic • Agricultural Installations • Security Lighting and Burglar Alarms • Fire Alarm Systems • Additional Electrical Circuits • Faults • Breakdowns • Panel and Night Store Heaters supplied.

**No call-out charges, No VAT, Free estimates**

## Peter Allen

*FLOOR COVERINGS*

- Quality Pine & Oak Furniture
- Beds and Mattresses
- Karndean Design Showroom

**UNIT 2, SOWARTH FIELD INDUSTRIAL ESTATE, SETTLE**

**Telephone 01729 825122**

Open Mon, Tues, Thurs & Fri 10am to 4pm.  
Wednesday & Saturday 10am to 12.30pm

## Settle Chimney Sweep Services



**4 Craven Terrace  
Settle BD24 9DB**

**Supplier of pots, cowls & bird nets**

**Tel. 01729 823683**

**Mobile. 07815 285321**

## Septic tanks

*Emptying & Maintenance*

**P J Richardson**

*Registered Waste Carrier No. NYK/642908*

**CLAPHAM, LANCASTER**

**Telephone 015242 51488**

**Mobile 07885 462 909**



## Jenny M Parker

Bsc (Hons), MCSP, HPC

**Chartered Physiotherapist**

Specialising in the rehabilitation and prevention of injury

Mobile physiotherapy service offering comprehensive assessment and treatment of joint and spinal problems, sports injuries, respiratory and neurological conditions, all in the comfort of your own home. Cover for sporting events also available.

*Please call to discuss your requirements and to book appointments.*

**Telephone: 015242 51049**

**Mobile: 07763 047160**

Knitting Needle Craft Haberdashery Sewing Card Making

## Cottontail Crafts

**VISIT OUR SHOP and WEBSITE**  
over 4000 great crafting products

**16 Duke Street SETTLE BD24 9DN**

**www.cottontailcrafts.co.uk**

**sue@cottontailcrafts.co.uk**

**01729 822946**

*A Paradise for Crafters*

## NATIONAL WATER WELL ENGINEERS



**Domestic & Agricultural  
Water Well Drilling  
Installation of Water Mains**

**Turnerford Cottage, Keasden, Clapham LA2 8EX**

**Tel. 015242 51013 or 07801 747632**

**email: waterwells@hotmail.co.uk**

**www.nationalwaterwellengineers.co.uk**

This free Newsletter aims to keep everyone in Clapham, Keasden and Newby in touch with what is happening in our community. It does, however, cost a significant amount to produce, and advertising is a very necessary aid to the finances. An advert costs as little as £3.50 per issue. To advertise your products and services, please contact Ray Hull on 015242 51610 or hull365@btinternet.com.

Articles, news and ideas please for the next issue

by **25th September, 2015** to

Chrissie Bell: ChrisHarte@aol.com

or Ray Hull: hull365@btinternet.com



# Wildlife in Clapham

The blue tit is one of our commonest resident breeding birds. It is a small bird with a mixture of blues, yellows, greens and a touch of white and black in colouration. During the winter they form large flocks with other members of the tit family and roam around woods, gardens, meadows and parks looking for food, it is also a regular user of bird feeders in gardens.

In the breeding season they use natural holes in trees, nest boxes, holes in buildings, walls and other man-made structures. They have seven to thirteen young in one brood but only a small percentage will survive to the following breeding season. That is why they have large broods with the hope one or two might make it through to the following breeding season to carrying on their genes. This time of year the young will have fledged and they look duller than the adults, they will also be learning how to survive in the wild world. The adults will be silently moulting their feathers after a hectic breeding season.

A new species of bird was seen in the local area at the end of May or early June. Two stone curlews were seen in a field near Dovenanter House by a local gamekeeper and reported to me by Pete Richardson. At the same time two more were seen in Cheshire and several were seen in North Lincolnshire and East Yorkshire. Stone curlews used to breed in Yorkshire but disappeared over a hundred years ago as they did right across the rest of the country. They breed now only in Norfolk and Suffolk and a few counties on the South coast. The stone curlews were only present in the field for one day.

Another new species has also been seen in the local area, a male broad-bodied chaser (dragonfly) was seen at Ingleborough Hall on July 14th. The males are a medium sized dragonfly with a bright blue bulky body. Over the last five to ten years they have been spreading slowly northwards. They used to breed only as far as the Midlands; they have now reached north Cumbria and parts of southern Scotland. Two days later a banded demoiselle which is another dragonfly was seen at Ingleborough Hall;



*Blue Tit – Parus Caeruleus*

I saw my last banded demoiselle around here at the River Wenning near Clapham Station about six years ago.

Lots of young swallows, swifts and house martins have been seen feeding with their adults around the local area. One juvenile cuckoo was seen at Ingleborough Hall on 23rd July, this bird will be moving around the local area and feeding up getting ready to move south for the winter. One juvenile grey heron has spent several days during the middle of July on Clapham Beck at Brokken Bridge.

*Tim Hutchinson, Smithy Cottage*

## Clapham Playpark

We now have a team of volunteers available to mow the playpark on a weekly basis, though if you'd like to help, or have offered to help in principle but haven't been able to give a definite time yet, please contact Don on 51775.

We had hoped that the new shelter would have been installed by now but the company we've placed an order with have been very busy. We hope it will be installed by the end of August.

*Tracey Bilton (015242 51856)  
Clapham Park Association*



YORKSHIRE DALES  
**pilates**  
and yoga

**Jess Bagnall**  
**The i Centre, Ingleton**

07754 792952

jess@yorkshiredalespilates.com

[www.yorkshiredalespilates.com](http://www.yorkshiredalespilates.com)





*Linda and Melanie sell Posh Pots*



*Barbara raising funds on the tombola stall*



*Justina and Alison – flowers of St. Boniface*



*Tackling the wall at the Cave Rescue*



*Brenda between the romance and fiction*